

1. ГОЩЕЛ
2. ЛИС DE FIXATION DU ГОЩЕЛ ET DE LA САСНЕ
3. БГАОНЕ DE LA САСНЕ
4. БОИШЕ DE LA САСНЕ
3. ЛИС DE FIXATION DE LA БОИШЕ INTERIEUR
5. БОИШЕ INTERIEUR
4. БОИШЕ EXTERIEUR

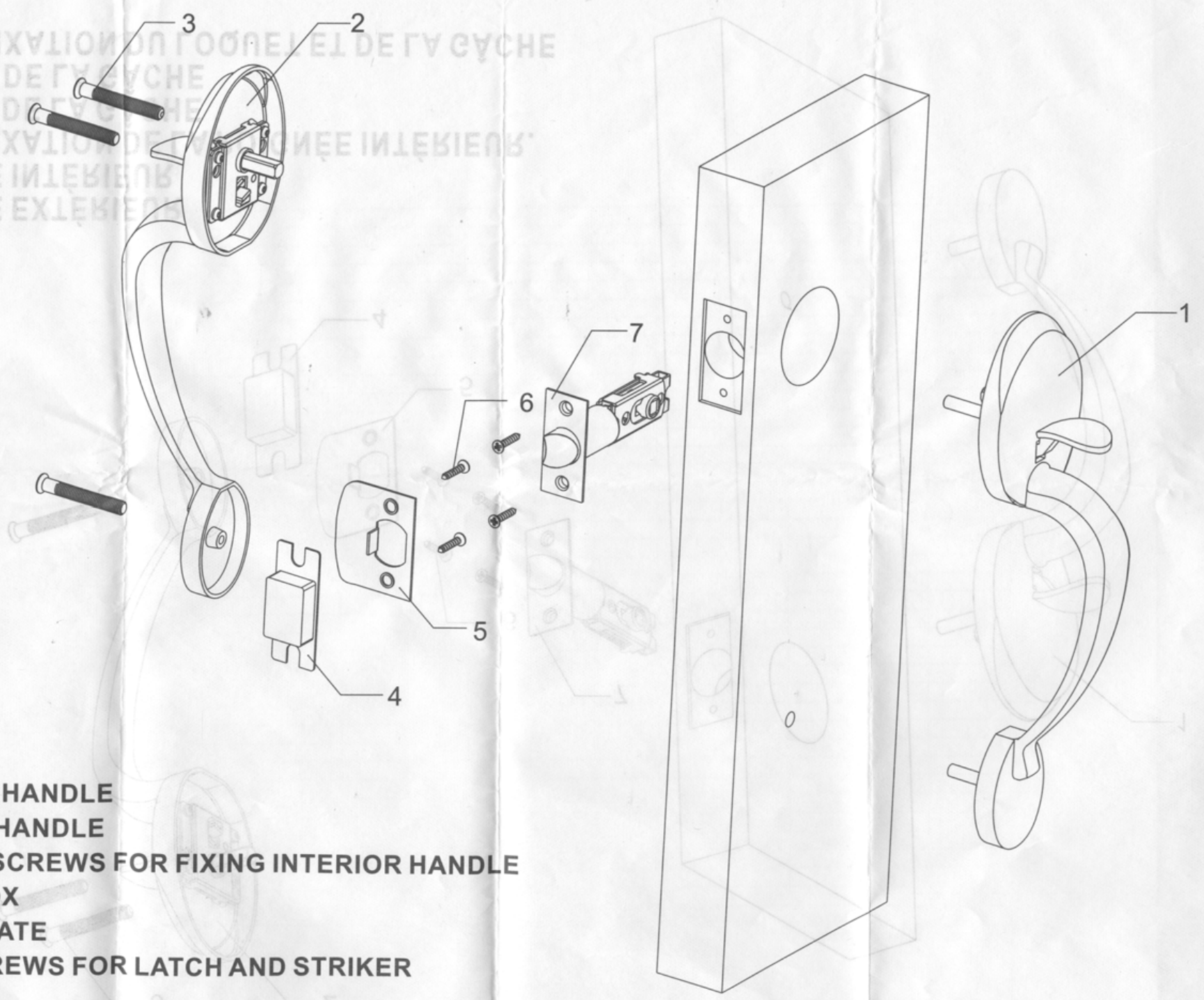

- 1. EXTERIOR HANDLE
- 2. INTERIOR HANDLE
- 3. MACHINE SCREWS FOR FIXING INTERIOR HANDLE
- 4. STRIKE BOX
- 5. STRIKE PLATE
- 6. WOOD SCREWS FOR LATCH AND STRIKER
- 7. LATCH